

NOTE:
 THE BOUNDARY OF THE OPERATING AREA IS SHOWN WITH HATCHING
 THE AREA INCLUDES RECLAIMED LAND AND PROJECTIONS INTO OR OVER THE WATER.

SEPTAGE AND SPECIALIST LIQUID WASTE SERVICES (EG GREASE TRAP WASTES) ARE PROVIDED BY OTHERS.

BOUNDARY BETWEEN CADASTRAL POINTS IS SHOWN WITH A DOTTED LINE

COMMENCEMENT DATE OF LICENCE.....

TERM OF LICENCE 25 YEARS.....

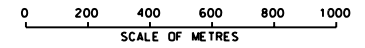

3114 55

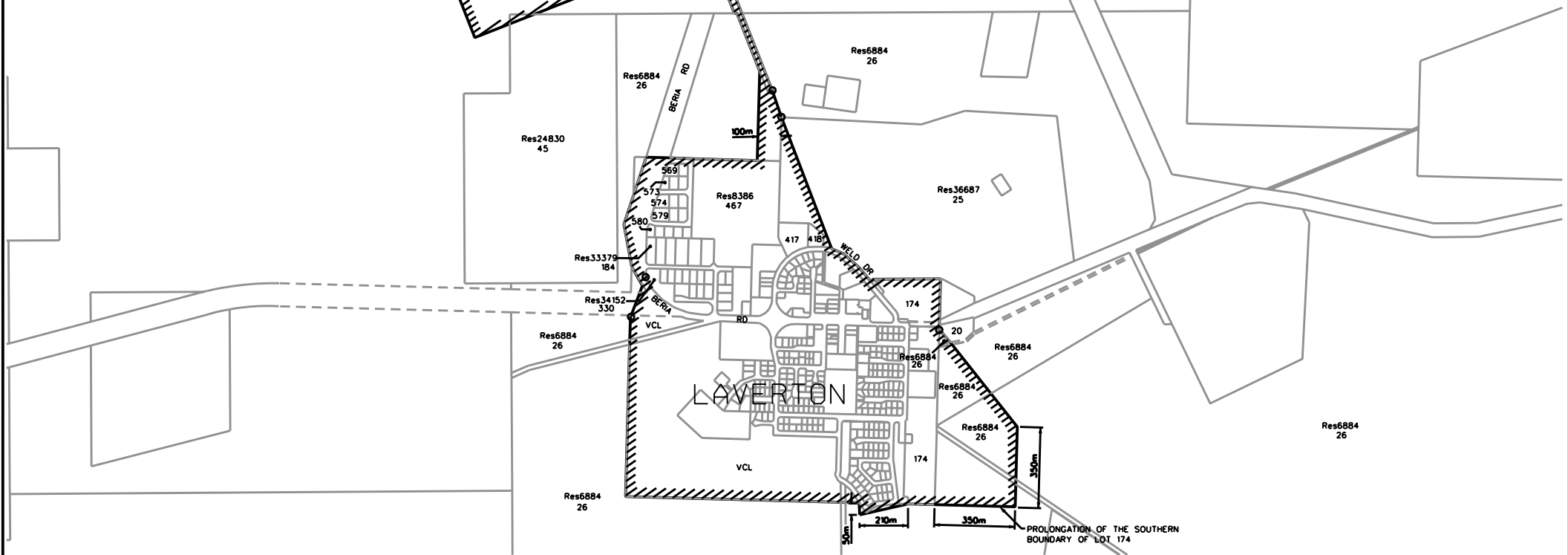
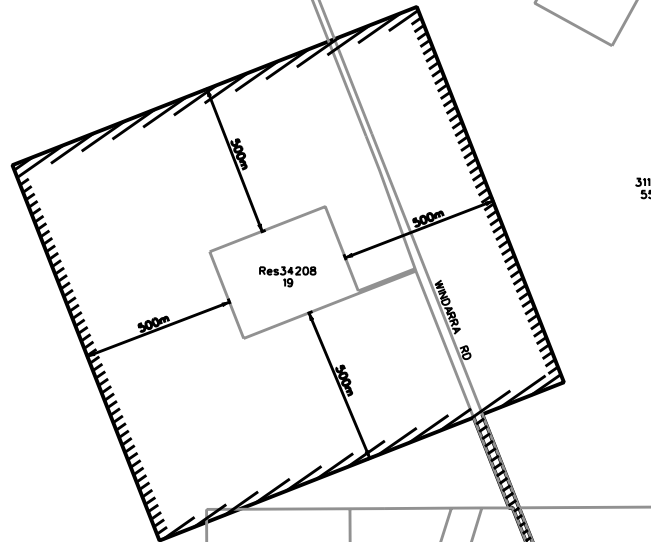

DATE	No.	DESCRIPTION	DRN	CHK
24-05-2004	C	AMENDED OPERATING AREA	PD	
08-09-1999	B	AMENDED OPERATING AREA	SM	JH
18-12-1995	A	ORIGINAL ISSUE - DRG OWR-OA-011	NN	WC



APPROVED : L. ROWE
 DATE : 01/09/2004

**WATER SERVICES LICENSING ACT 1995
 LAVERTON OPERATING AREA
 SEWERAGE SERVICES
 LICENSEE : WATER CORPORATION**

DRAWN S.MASTERS	CHECKED J.HARRIS	DATE 8 SEPTEMBER 1999	PLAN NO. OWR-OA-011
FILE No.			ISSUE C

ORIG SIZE
A3