

NOTE:  
 THE BOUNDARY OF THE OPERATING AREA  
 THE AREA INCLUDES RECLAIMED LAND AND  
 PROJECTIONS INTO OR OVER THE WATER.

SEPTAGE AND SPECIALIST LIQUID WASTE SERVICES  
 (EG GREASE TRAP WASTES) ARE PROVIDED BY OTHERS.

BOUNDARY JOINING CADASTRAL POINTS

COMMENCEMENT DATE OF LICENCE.....  
 TERM OF LICENCE, YEARS.....

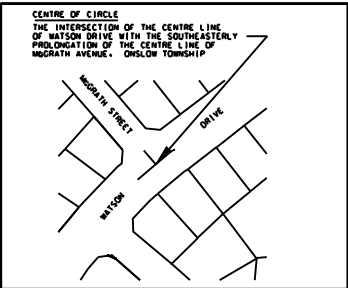
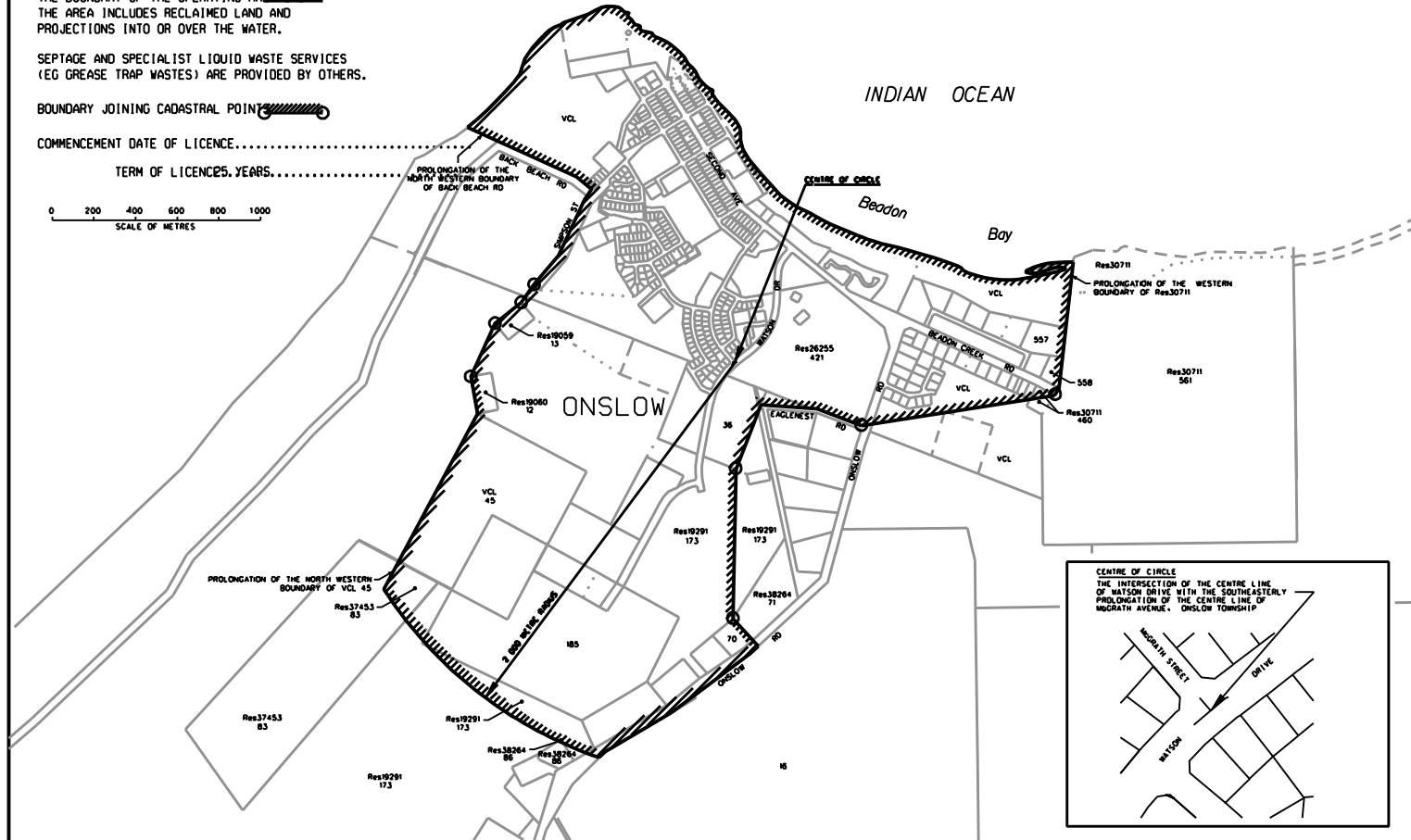
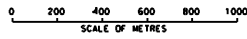

DATE	No.	DESCRIPTION	DRN	CHK
09-09-1999	B	AMENDED OPERATING AREA	BH	JH
09-12-1998	A	ORIGINAL ISSUE - DEC 01R-04-971	MWP	MJP



APPROVED:  
 SCD. *Brian Martin*  
 COORDINATOR OF WATER SERVICES  
 DATE: 3 / 4 / 00

WATER SERVICES CO-ORDINATION ACT 1995  
 ONSLOW OPERATING AREA  
 SEWERAGE SERVICES  
 LICENSEE : WATER CORPORATION

DRAWN S.MASTERS	CHECKED J.HARRIS	PLAN NO. OWR-0A-071	ISSUE B	SCALE A3
FILE NO.	DATE 28 SEPTEMBER 1999			