

# THREE SPRINGS

NOTE:  
 THE BOUNDARY OF THE OPERATING AREA IS SHOWN BY A HATCHED LINE.  
 THE AREA INCLUDES RECLAIMED LAND AND PROJECTIONS INTO OR OVER THE WATER.

SEPTAGE AND SPECIALIST LIQUID WASTE SERVICES (EG GREASE TRAP WASTES) ARE PROVIDED BY OTHERS.

COMMENCEMENT DATE OF LICENCE.....  
 TERM OF LICENCE 25 YEARS.....

0      200      400      600      800      1000  
 SCALE OF METRES

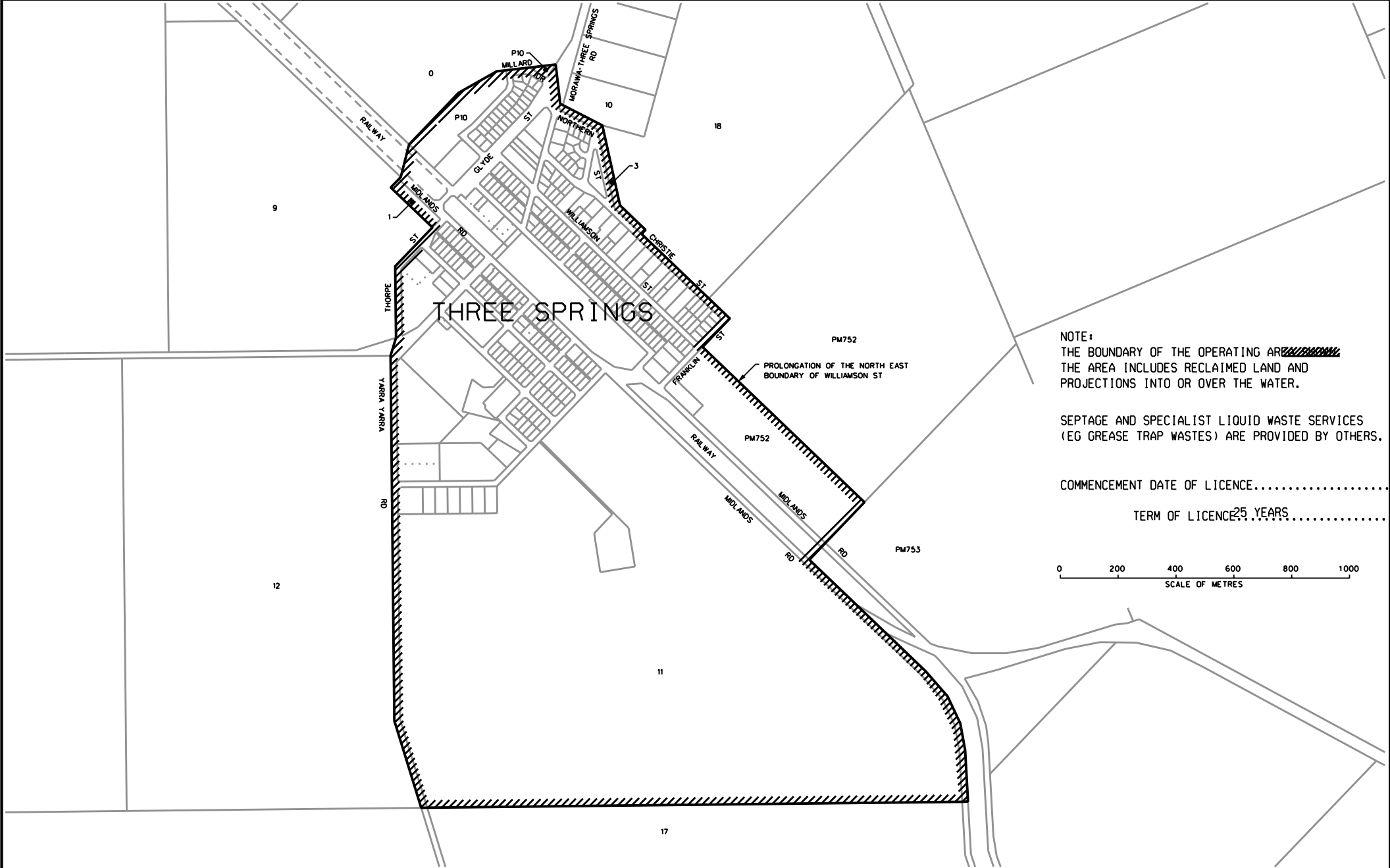

| DATE       | No. | DESCRIPTION                     | DRN | CHK |
|------------|-----|---------------------------------|-----|-----|
| 24-05-2004 | C   | AMENDED OPERATING AREA          | PD  |     |
| 05-10-1999 | B   | AMENDED OPERATING AREA          | SM  | JH  |
| 14-12-1995 | A   | ORIGINAL ISSUE - DRG OWR-OA-001 | NM  | WC  |



APPROVED : \_\_\_\_\_ L. ROWE \_\_\_\_\_  
 DATE : 01/09/2004

WATER SERVICES LICENSING ACT 1995  
 THREE SPRINGS OPERATING AREA  
 SEWERAGE SERVICES  
 LICENSEE : WATER CORPORATION

|                    |                        |                               |                   |                           |
|--------------------|------------------------|-------------------------------|-------------------|---------------------------|
| DRAWN<br>S.MASTERS | CHECKED<br>J.HARRIS    | PLAN NO.<br><b>OWR-OA-061</b> | ISSUE<br><b>C</b> | ORIG<br>SIZE<br><b>A3</b> |
| FILE No.           | DATE<br>5 OCTOBER 1999 |                               |                   |                           |